



For office use
MSGC# 97.0003

Michigan Stained Glass Census FORM A: Building Data and Location of Windows

(Please type or print in black ink.)

Date: Jan 10, 1997

Census Taker: Louise Vermilyea

Organization _____

Address: PO Box 100 Holtom MI 49425
number street city zip

County: Muskegon Telephone: (616) 821-2323

No. of slides included: _____ No. of photos: 8

=====

BUILDING SKETCH PLAN

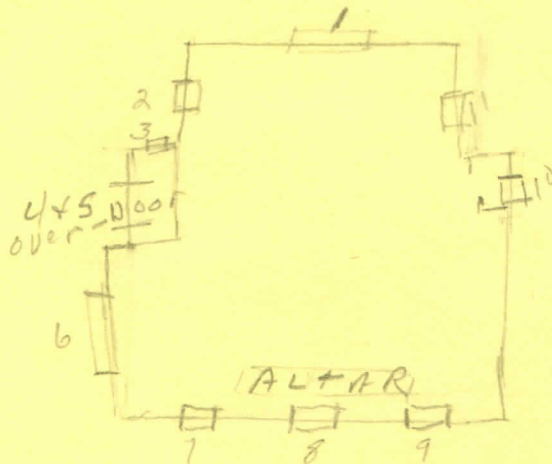

Name of Building: Holtom United Methodist Church

Function or type: Church

Address: 6525 Holtom-Whitehall Rd Holtom MI 49425
number street city zip

Contact Person, Title: Louise Vermilyea Phone: (616) 821-2323

Date of construction: 1915 Architect, city: _____

Dates of alteration: _____ Architect, city: _____

No. of pictorial windows _____ No. of non-pictorial windows 11
(including scenic, symbolic, historic, humanitarian, etc.)

Archival sources for building information: _____